

**SUCTION LINE PIPEWORKS**  
Scale 1:100

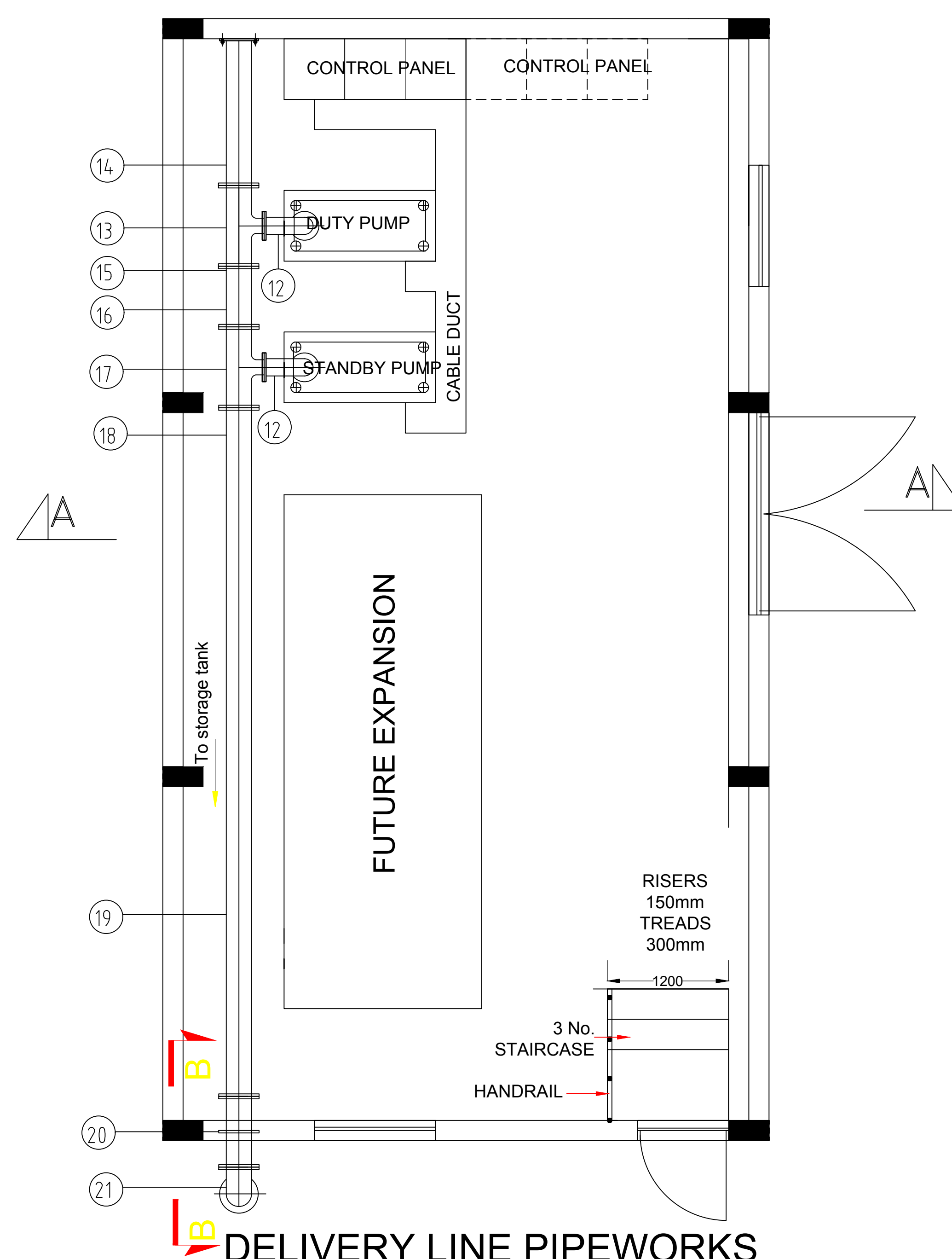

**DELIVERY LINE PIPEWORKS**  
Scale 1:100

**SUNCTION AND DELIVERY LINE PIPEWORK SCHEDULE**

ITEM No	DESCRIPTION	DIA. (mm)	PN	LENGTH (m)	QUANTITY (No.)
<b>I SUCTION LINE PIPEWORK</b>					
①	DOUBLE FLANGED TAPER WITH BLANK FLANGE	100	16	0.45	4
②	FLANGED GATE VALVE	100	16		4
③	FLANGED ADAPTOR	100	16		4
④	SINGLE FLANGED PIPE WITH PUDDLE FLANGE	100	16	0.95	4
⑤	DOUBLE FLANGED PIPE	100	16	1.4	4
⑥	DOUBLE FLANGED PIPE WITH CENTRAL PUDDLE FLANGE	100	16	0.7	4
⑦	FLANGED PIPE WITH FOOT VALVE & STRAINER	100	16	3.4	4
<b>II DELIVERY LINE PIPEWORK</b>					
⑧	DOUBLE FLANGED TAPER	100	16		2
⑩	FLANGED NON RETURNED VALVE	100	16		2
⑪	FLANGED GATE VALVE	100	16		2
⑫	90° FLANGED BEND	100	16		2
⑬	ALL FLANGED REDUCING TEE	100	16		1
⑭	DOUBLE FLANGED PIPE	100	16	30	5
⑮	DOUBLE FLANGED TAPER	100	16		1
⑯	DOUBLE FLANGED SHORT PIPE	100	16		1
⑰	ALL FLANGED REDUCING TEE	100	16		2
⑱	BLANK FLANGE	100	16		2
⑲	DOUBLE FLANGED PIPE	100	16	5.4	1
⑳	DOUBLE FLANGED PIPE WITH PUDDLE FLANGE	100	16	0.7	1
㉑	90° FLANGED BEND	100	16		2
㉒	DOUBLE FLANGED PIPE	100	16	0.6	4
㉓	FLANGED ADAPTOR	100	16		2
㉔	BULK WATER METER	100	16		1
㉕	HDPE PIPE WITH 1 No. REDUCING COUPLER 100X90mm AT START POINT	90	16	1400	14

**NOTES**

1. All dimensions are in millimeters unless otherwise stated
2. This drawing must not be scaled only figured dimensions should be used
3. All masonry walls must be reinforced with 25mm hoop iron after every two alternate courses
4. All mortar used to be of cement sand mix 1:3, with all the stone walling being laid in 200mm courses with 12mm mortar joints
5. A minimum of 7.0N/mm<sup>2</sup> average compressive strength of masonry in accordance with BS5390 should be used for all wall sections
6. Mass concrete to be grade 15

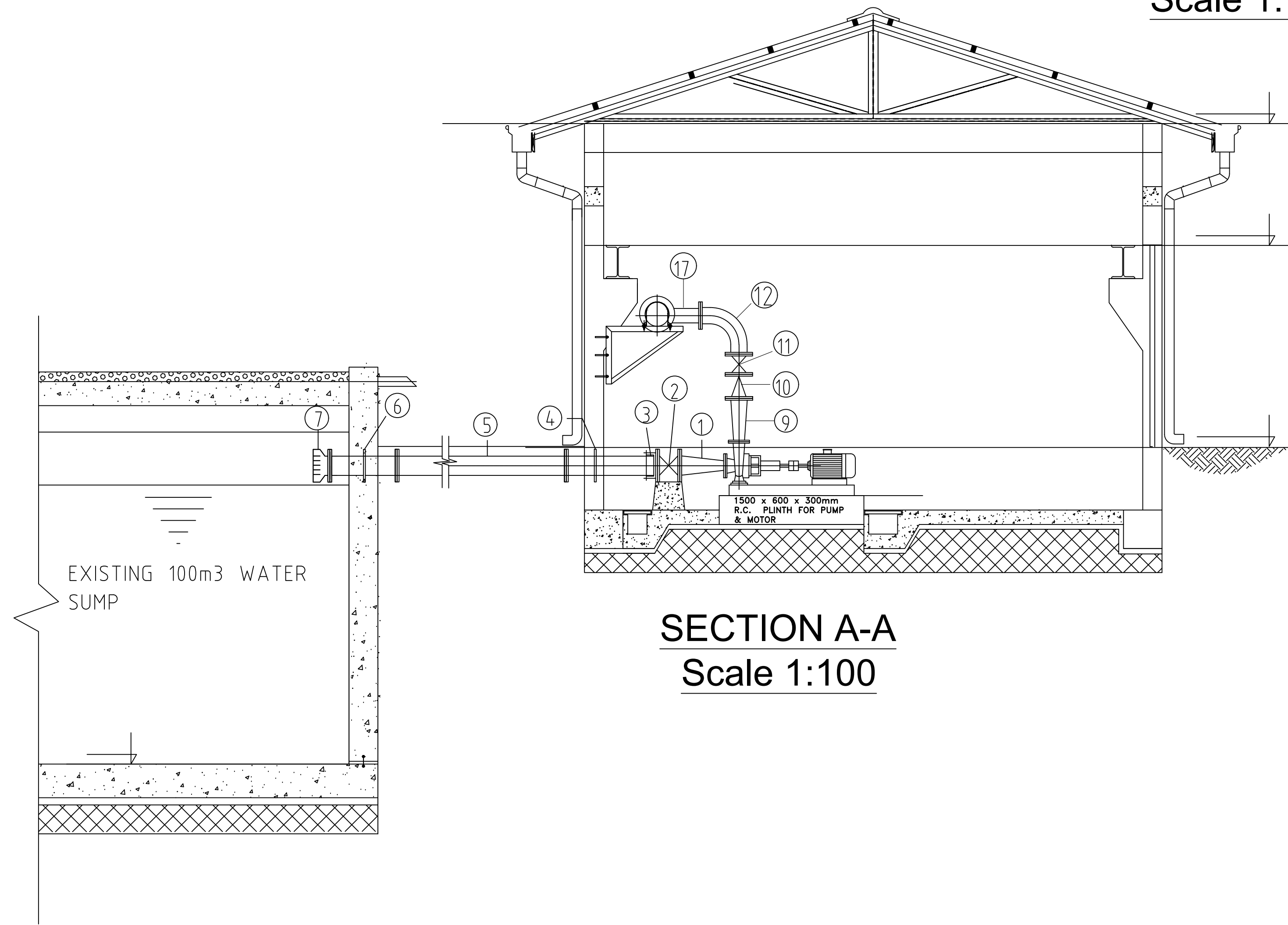

**SECTION A-A**  
Scale 1:100

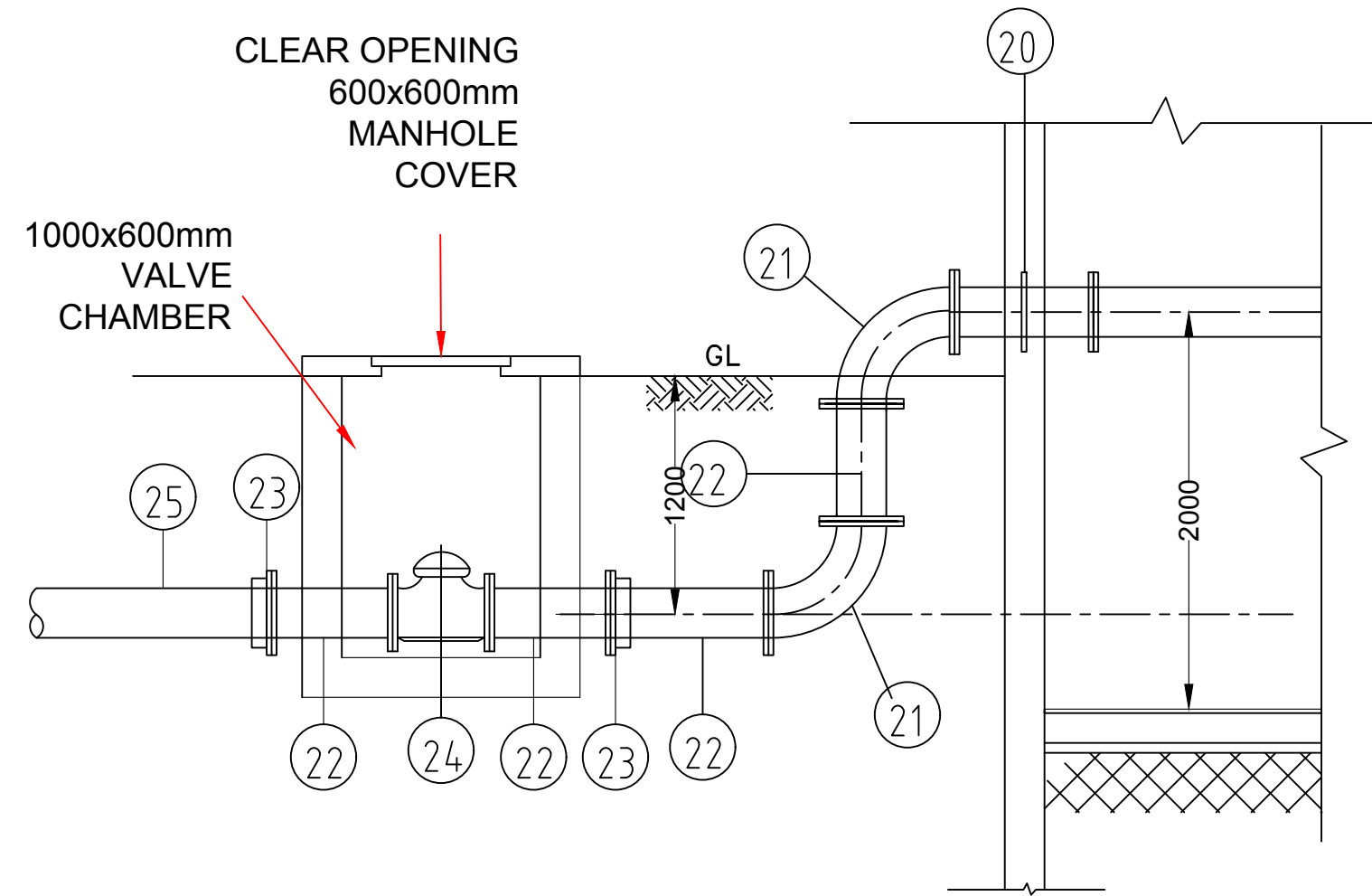

**SECTION B-B**  
Scale 1:100

<b>KAKAMEGA COUNTY WATER AND SANITATION COMPANY</b> P.O. BOX 1189 - 50100 <b>KAKAMEGA</b>			
<b>PROPOSED CONSTRUCTION OF NEW PUMP HOUSE AT MALAVA WATER SUPPLY INTAKE - SUCTION AND DELIVERY PIPELINE ASSEMBLY AND SCHEDULE</b>			
DRAWN BY	J.O	MAY 2021	SCALE: AS SHOWN
DIGITIZED BY	J.O	MAY 2021	DRG. NO. 3 of 3
CHECKED BY	Eng C.A	MAY 2021	KACWASCO
APPROVED BY	Eng A.M.A	MAY 2021	